

# DIGITAL DRUM

## Instruction Manual



# Congratulations!

Thank you for purchasing this digital drum module. The drum module has been developed to act and play like a drum set but with greater ease. Before you use the instrument, we recommend you to read through this manual.

## Taking Care of Your Digital Drum Set

### Location

- Do not expose the unit to the following conditions to avoid deformation, discoloration, or more serious damage.
- Direct sunlight.
- High temperature (near a heat source, or in a car during the day time).
- Excessive humidity.

### Power Supply

- Make sure to sure use the suitable AC adaptor, and also make sure the AC outlet voltage at your country matches the input voltage specified on the AC adaptor`s label.
- Turn the power switch OFF when the instrument is not in use.
- An AC adaptor should be unplugged from the AC outlet if the instrument is not be used for an extended period of time.
- Unplug the AC adaptor during electric storms.
- Avoid plugging the AC adaptor into the same AC outlet as appliance with high power consumption, such as electric heaters or ovens. Also avoid using multi-plug adaptors since these can result in reducing the sound quality, operation errors, and possibly damage.

### Turn Power OFF When Making Connections

- To avoid damage to the instrument and other devices to which it is connected, turn the power switches of all related device OFF prior to connecting or disconnecting cables.

### Handling and Transport

- Never apply excessive force to the controls, connectors or other parts of the instrument.
- Always unplug cables by gripping the plug firmly, but not pulling on the cable.
- Disconnect all cables before moving the instrument.
- Physical shocks caused by dropping, bumping, or placing heavy objects on the instrument can result in scratches and more serious damage.

### Cleaning

- Clean the unit with a dry soft cloth.
- A slightly damp cloth may be used to remove stubborn grime and dirt.
- Never use cleaners such as alcohol or thinner.
- Avoid placing vinyl object on top of the unit (vinyl can stick to and discolor the surface).

### Electrical Interference

- This instrument contains digital circuitry and may cause interference if placed too close to radio or television receivers. If this occurs, move the instrument further away from the affected equipment.

# Contents

<b>Panel Controls</b> .....	<b>4</b>
- Front Panel .....	4
- Rear Panel .....	5
- Side Panel .....	5
<b>Setup</b> .....	<b>6</b>
- Connect the Pads and the Pedal .....	6
- Connect a MIDI device .....	7
- Connect a audio equipment .....	7
- Connect a CD player, etc.(Aux in jack) .....	7
- Connect Headphones .....	7
- Connect the Power supply jack .....	7
<b>Functions</b> .....	<b>8</b>
- Switch the power ON .....	8
- Set the main volume .....	8
- Select a drum kit .....	8
- Play with a Metronome .....	8
<b>Play a Song</b> .....	<b>9</b>
- Select a Song .....	9
- Listen to the Song .....	9
- Adjust the Song's volume .....	9
- Adjust the Song's tempo .....	9
- Tap tempo function .....	10
- Mute a Drum part .....	10
- Play with a Click voice .....	10
- Use the lighting guide function .....	10
<b>Creat a User Drum Kit</b> .....	<b>11</b>
- Set a drum voice .....	11
- Adjust the volume of Pad .....	11
- Save your drum kit voices .....	11
<b>Specifications</b> .....	<b>12</b>
<b>Voice list</b> .....	<b>13</b>
<b>Preset kit list</b> .....	<b>14</b>
<b>Song list</b> .....	<b>14</b>
<b>MIDI implementation chart</b> .....	<b>15</b>

# Panel Controls

## Front Panel

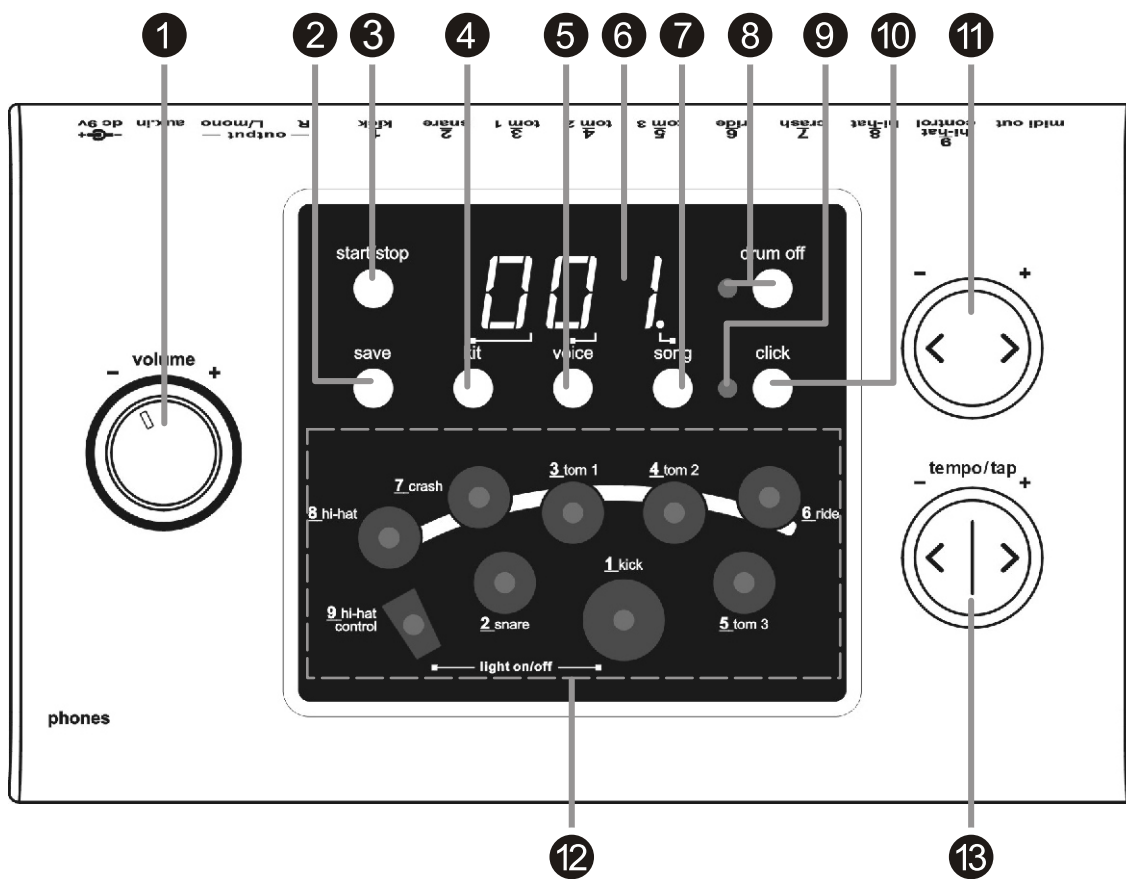

- 1 Volume knob**  
Control the volume of phone and line output. Turn it clockwise to increase the volume and anticlockwise to decrease it.
- 2 [ save ] button**  
Save current kit setting to a user kit.
- 3 [ start/stop ] button**  
Start or stop song playing.
- 4 [ kit ] button**  
Display the drum kit number.
- 5 [ voice / volume ] button**  
Display the voice number or volume value.
- 6 3-digit LED display**  
Display the parameters of current menu mode.
- 7 [ song / volume ] button**  
Display the song number or accompaniment volume value.
- 8 [ drum off ] button and indicator**  
This button is used to turn on or turn off the percussion of song.
- 9 Beat indicator**  
Beat of metronome or a song is playing
- 10 [ click ] button**  
Turn on or off the metronome.
- 11 [ + ] and [ - ] buttons**  
These buttons are used to change the setting number of kit, voice, song and adjust the Pad volume.
- 12 Pad select buttons and indicators**  
Select current pad and adjust the pad volume. When you press them, the corresponding indicator lights up.
- 13 [ tempo - / + ] and [ tap ] buttons**  
Change current tempo.

## Rear Panel

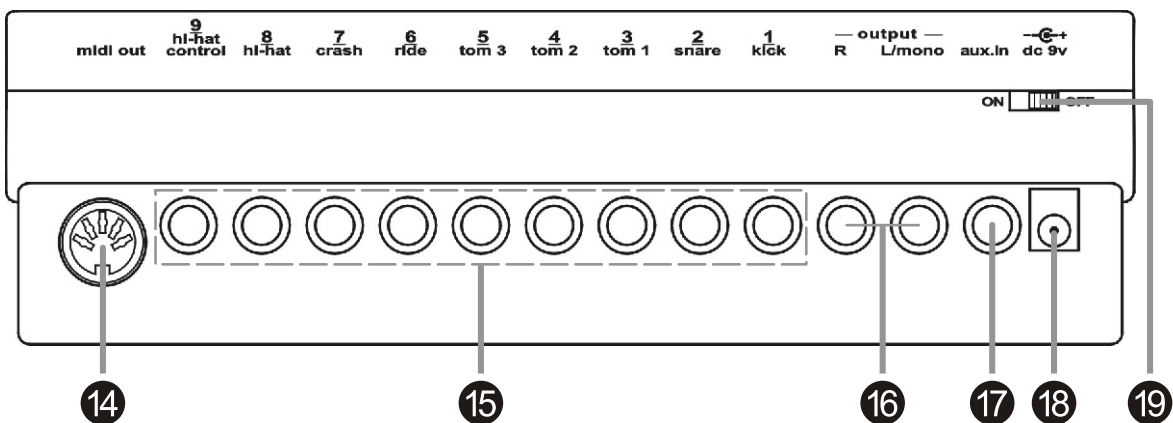

### 14 MIDI out jack

Connect with external sound module.

### 15 Trigger input jacks

Connect with pads, cymbals, hi-hat control, kick trigger.

### 16 Output jacks (R, L/mono)

Connect with the amplifier or audio system.  
For monaural output use the L/mono jack.

### 17 Aux.in jack

Connect with external sound source.

### 18 Power supply jack ( DC in 9V)

Connect an AC adaptor to this jack

### 19 Power switch

Turn the power on/off

## Side Panel

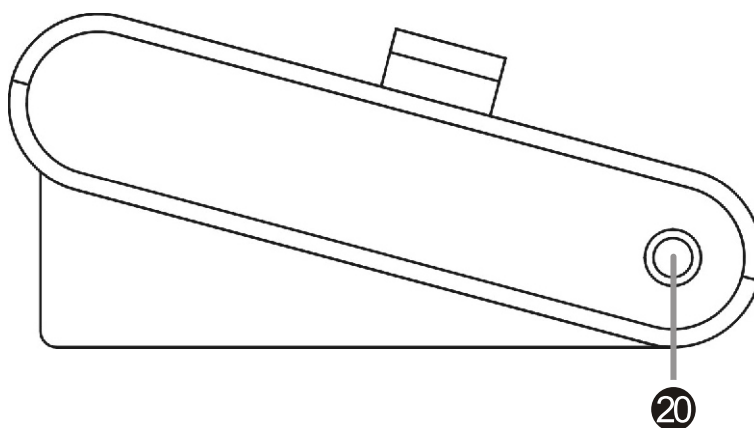

### 20 Phones jack

Connect with to a pair of stereo headphones to this jack.  
(Connect the headphones will not mute the output jacks.)

# Setup

**Caution!**  
 To prevent electric shock and damage to the device, make sure the power is switched OFF on the drum and all related device before making any connection.

## Connect the Pads and the Pedals

Using the provided cables, connect each Trigger input jack on the rear panel of the module, and make sure each pad is connected to its corresponding Trigger input jack.

**Note:**

1. The voice of hi-hat pad hitting is controlled by hi-hat pedal. Similar to a real drum kit, the hi-hat pad functions as an 'open hi-hat' when the pedal is stepped. When the pedal is released, it functions as a 'closed hi-hat'.
2. The valid striking area of a cymbal pad (ride, crash or hi-hat) is near the edge of the pad, which is different from other pads.

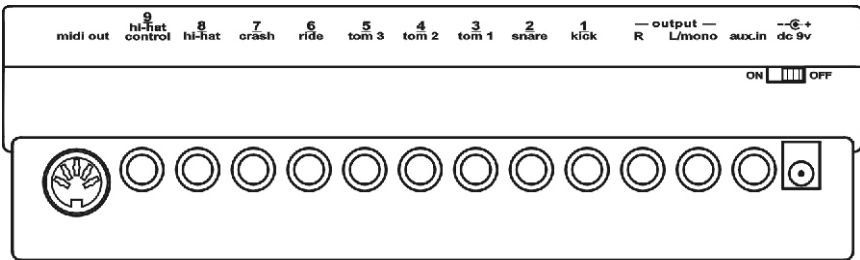
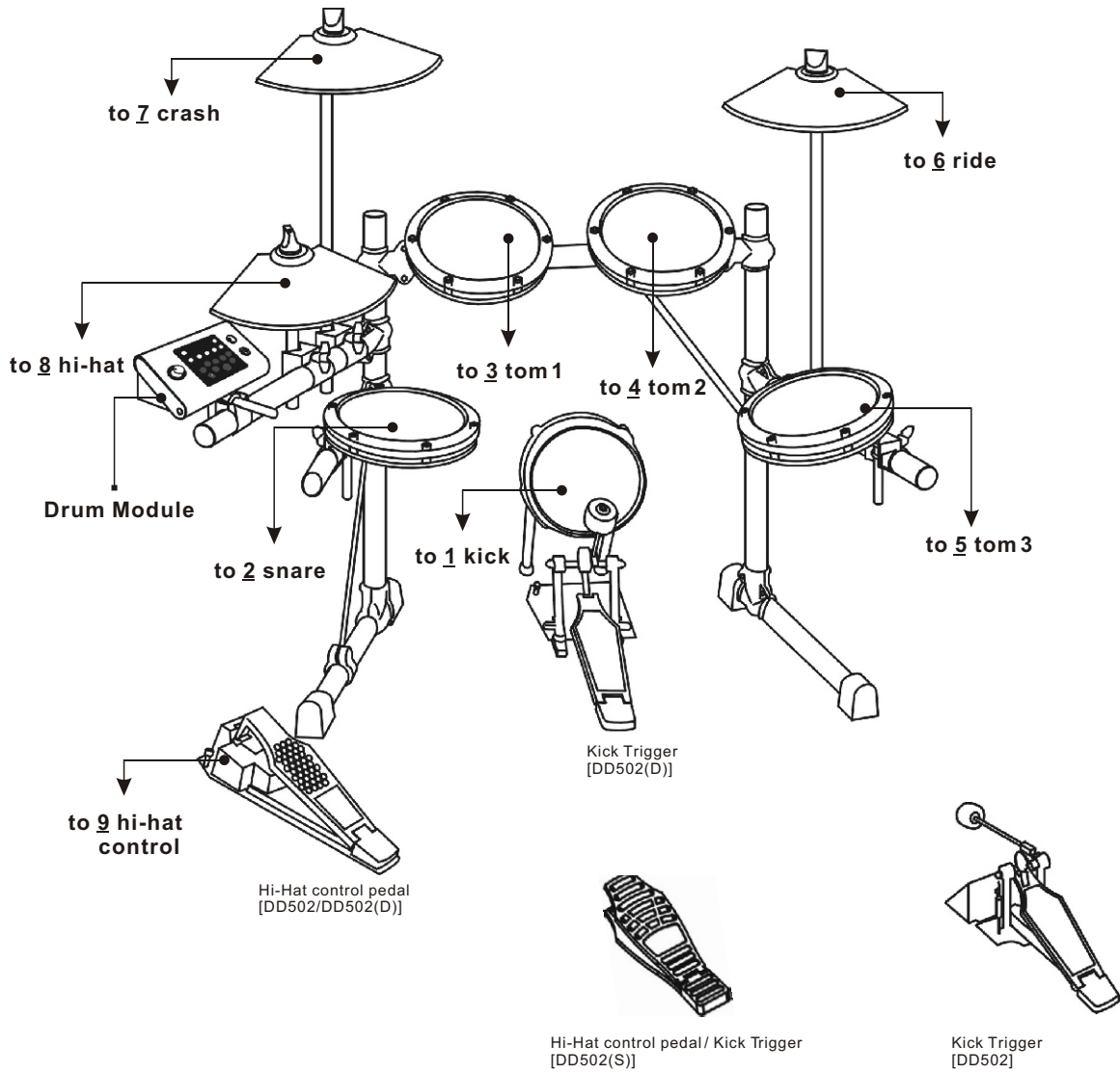

## Connect a MIDI device

This is for you want to use an external sound module or MIDI sequencer.

### Transmit MIDI Data

1. Use a MIDI cable to connect the MIDI OUT jack on the drum module with the MIDI IN jack on the external MIDI device.
2. This drum will output all the MIDI codes generated by pads hitting or pedal stepping via the MIDI output connector. But clicking and the MIDI codes in songs are excluded.

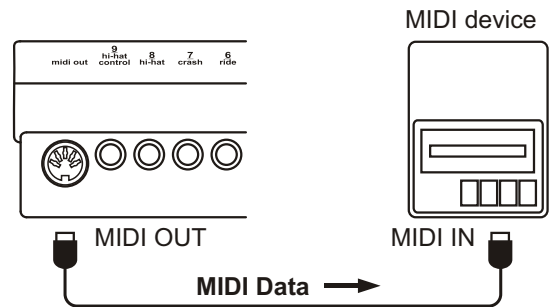

## Connect a audio equipment

1. When you want to listen to the voices with an amplifier, connect amplifiers with the Output L/MONO and R jacks on the rear panel. (For monaural playback, use the L/MONO jack; for stereo playback, connect both L/MONO and R jacks.)
2. The volume is adjusted with the VOLUME knob.

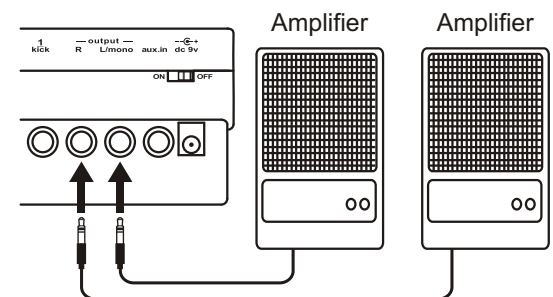

## Connect a CD player, etc.(Aux. In jack)

1. The audio output of a CD player, or other audio source, to connect with the AUX IN jack on the rear panel can be mixed with the sound of the drum. This function is convenient that lets you play along with a favourite song.
2. The volume of the external signal is adjusted with the VOLUME knob.

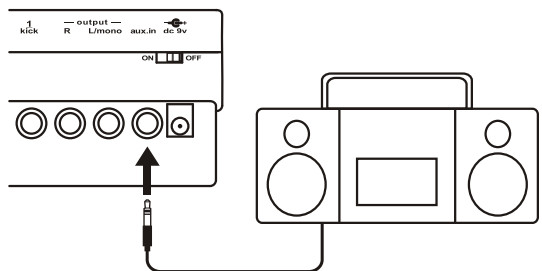

## Connect Headphones

An optional set of stereo headphones can be connected with the PHONES jack located on the side of the drum module.

- \* Adjust the volume to a comfortable level.

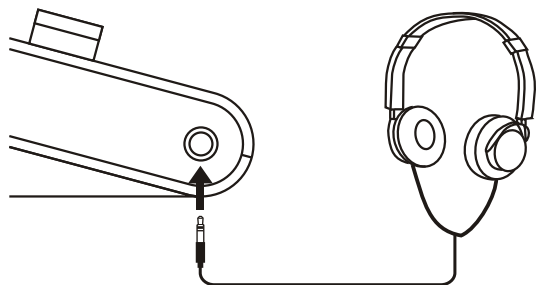

## Connect the Power supply jack

Make sure the power is switched OFF and connect the power adaptor with the DC IN jack on the rear panel.

### Note:

1. To protect the speakers, amplifier and the drum module from damage, rotate the volume knob to the minimum volume level before switching the power ON.
2. Make sure the power is switched OFF when connecting drum module with external devices.

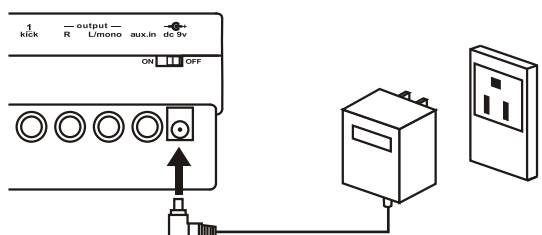

# Functions

## Switch the power ON

After confirming all connection have been completed, rotate the volume knob to the left ( minimum volume level) before switching the power on.

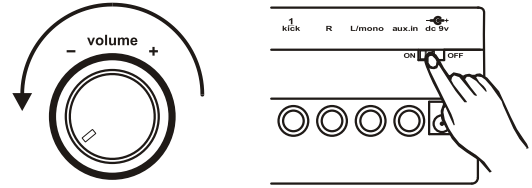

Set the power switch to "on" position to switch on the power. Display shows the song's number and its indicator lights up.



## Set the main volume

While hitting a pad, gradually rotate the volume knob until a comfortable volume level is reached.

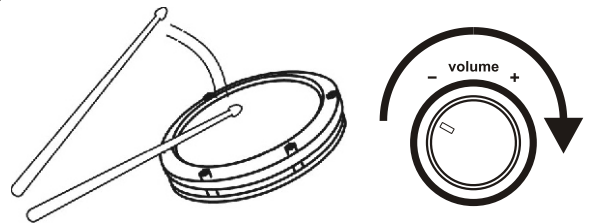

## Select a drum kit

The unit comes with 20 (001-020) preset drum kits and 10 user kits (021-030). (Reference song list : page 14.)

1. Press [ kit ] button  
The current kit number appears and the Kit indicator lights.
2. Press [ + ] or [ - ] buttons to select the drum kit number (001 - 020) you want to use.

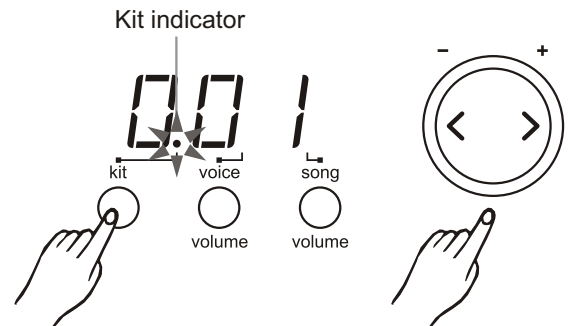

## Play with a Metronome

1. Press the [ click ] button to start the metronome. The beat indicator is flashing and the click sound begins to play.
2. Press the [ tempo + ] or [ tempo - ] buttons to set the metronome beat.
3. Press the [ click ] button again to stop the metronome.

### Adjust the volume of the click sound

Hold down the [ click ] button and press the [ + ] or [ - ] buttons to adjust the volume of the click sound, the metronome automatically play.

\*When playing the metronome:

The metronome stops immediately when holding down [ click ] button, and pressing the [ + ] or [ - ] buttons on the click sound.

\*Volume of the click sound will be reset to default once power is on.

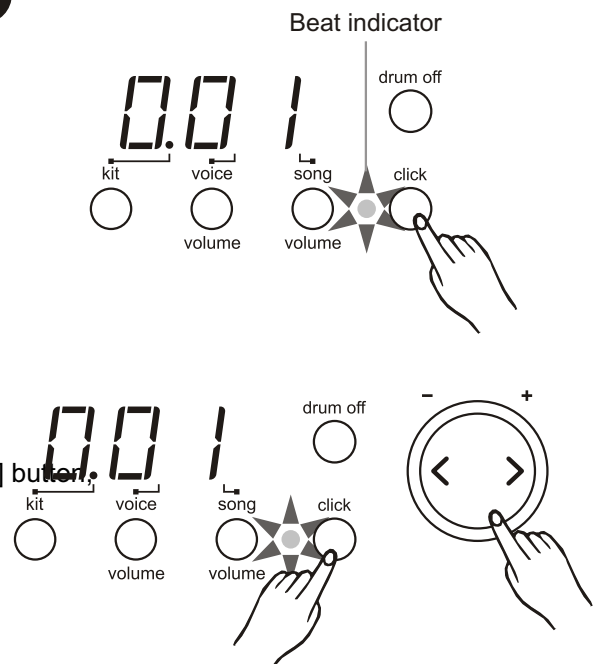

# Play a Song

## Select a song

This drum module has a total of 50 preset songs.  
Note: The preset song setting is 001 after you slide on power.

1. Press [ song / volume ] button.  
The song indicator lights and the current song's number appears.
2. Press [ + ] or [ - ] button to select one of the song and listen to it.  
Song numbers 001 - 050 are preset songs.  
(Reference song list : page 14.)

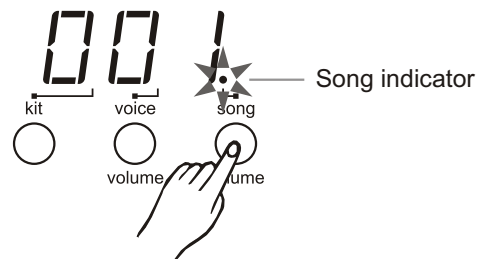

## Listen to the song

1. Press [ start/stop ] button and the beat indicator is flashing.  
After the counting, the song will start playback from the beginning.
  2. The song will stop when it reaches the end.  
You can stop the song during playback by pressing the [ start/stop ] button
- \* The ASSIGN pad's indicator flashes at the first beat of each measure

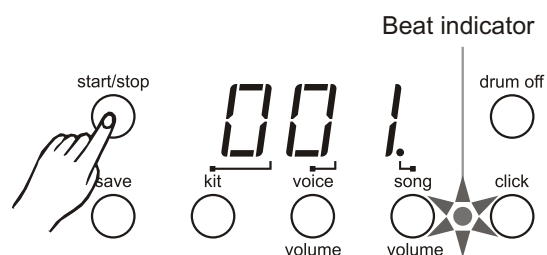

**Note:** The ASSIGN pad's indicator can be lighted off by pressing both [hi-hat] and [kick] button at the same time.

## Adjust the song's volume

1. Press the [ song / volume ] button to select the volume of song. Display shows : "A XX".  
(XX = level value, 00 to 31)
2. Press [ + ] or [ - ] button to adjust the volume of song accompaniment.

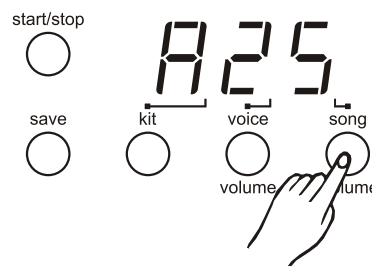

## Adjust the song's tempo

1. Press the [ tempo + ] or [ tempo - ] button. Display shows the current tempo value.
  2. Press the [ tempo + ] or [ tempo - ] button to increase or decrease the tempo. ( tempo value in the range or 30 to 280)
- \* Holding down either a [ tempo + ] or [ tempo - ] button to change the setting in a high speed.  
\* Press [ tempo + ] and [ tempo - ] buttons at the same time to reset the tempo to default value.

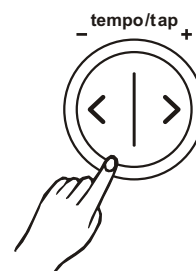

**Note:** About 2 seconds after you stop pressing the [Tempo] button, display changes to show your selected song or kit number instead of tempo value.

## Tap tempo function

This function allows you to set the song's tempo by tapping in tempo on a pad.

1. Press the [ tap ] button. Display shows the current tempo value.
2. Tap on the pad in the tempo that you want to get. Tap on the pad 4 times. The last two beats are only detected and are set as your desired speed.
3. The song will be played with your desired tempo you set. When the song is playing, you are not allowed to change the tempo with this tempo function.

\* Any pads can do the tap tempo function.

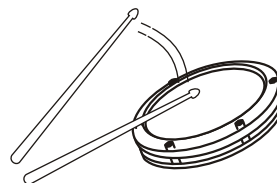
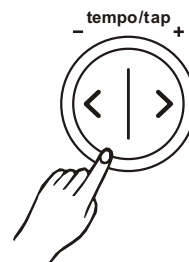

## Mute a Drum part

1. Press [ drum off ] button. The drum off indicator lights. The drum mute function is active.
2. Press [ start/stop ] button to playback the song. The drum part in the song will be muted.
3. To cancel the drum mute function, press [ drum off ] button again. The drum off indicator light goes off.

\* The drum mute function can be used during song playing.

Drum off indicator

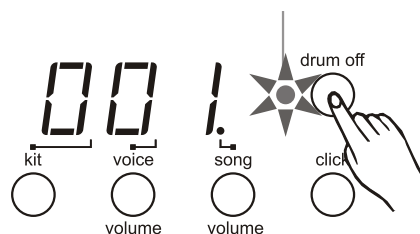

## Play with a the Click voice

1. Press the [ click ] button to start the metronome. It will be played with tempo.
2. Press the [ click ] button again to stop the metronome.

Note: The click voice will not stop automatically once the song finished until you press the [ click ] button.

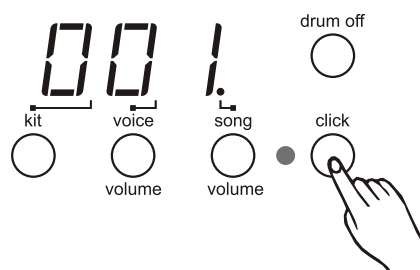

## Use the lighting guide function

The lighting guide function provides you a valuable lesson to practice or learn the drum kit with playing the preset song.

1. Select the song number you want to practice.
2. Press [ drum off ] button.
3. Press [ start/stop ] button to start song play.
4. Strike the pad in accordance with the lighting of pad's indicators or press the hi-hat pedal and kick the bass drum pad exactly when their indicators light.

\* During song playing, you can change the Tempo(speed), or use the tap tempo function to set your desired tempo.

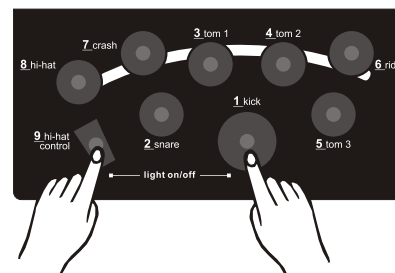

\* Press the [ hi-hat control ] + [ kick ] buttons to turn off all the pad's indicator. Press the [ hi-hat control ] + [ kick ] buttons again to turn on all the pad's indicator.

# Create a User Drum Kit

## Set a drum voice

The unit comes with 215 high quality percussion sounds that you can assign to any of the drum pad, 3 cymbals, hi-hat control and bass drum. This way you can create your own drum kit that consists of the voice you want. (Reference voice list : page 13.) The kit number 021-030 is use for saving your own drum kit.

1. Press [ voice ] button.  
The voice indicator lights and the display shows the voice number of this pad.
2. Press [ pad ] button or hit the pad you want to set. The pad indicator light and display shows the current voice number of lighting pad.
3. Press [ + ] or [ - ] buttons to select the voice number you want to assign.
4. Repeat step 2 and 3 for to set the voice for another pad or bass drum

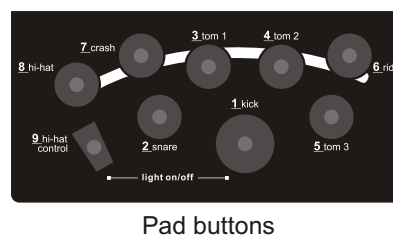

## Adjust the volume of Pad

This unit allows you to adjust the volume of every voices in the kit that let you control the individual level (volume) of the pads or bass drum.

1. Press the [ voice / volume ] button to select the volume level setting display shows : " L XX".  
(XX = level value, 00 to 31)  
The pad button indicator lights and display shows the current volume level of lighting pad.
3. Press the [ PAD ] button or kit the percussion pad you want to adjust.
4. Press the [ + / - ] to increase or decrease the volume. While you are adjusting, hit the corresponding pad and listen carefully the sound level until reaching the level you want.
5. Repeat step 3 and 4 to adjust the volume of other pad voices.

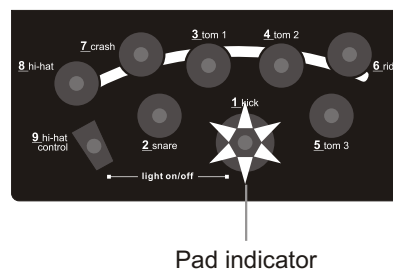
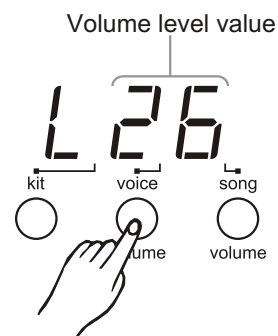

## Save your drum kit voices

Once completing to your own drum kit, you have to save them in the unit; otherwise your drum kit will be erased when you turn off the unit.

1. Press [ save ] button.  
The kit number 021 appears and is flashing.
2. Press [ + ] or [ - ] button to set the kit number (021-030) for saving your drum kit.
3. Press [ save ] button again. The flashing kit number stops.

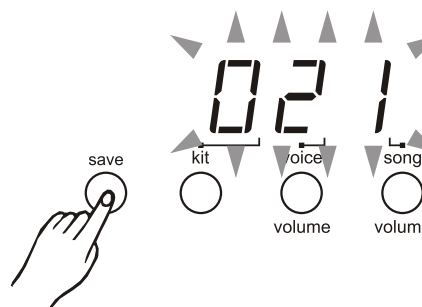

Note: To cancel the save operation, press the [ voice ] button. If there is a fault, the display will show "Err".

# Specifications

<b>Drum Pad:</b>	4 drum pads , 3 cymbal pads , 1 hi-hat control pedal , 1 kick trigger
<b>Voices:</b>	215 voices
<b>Drum kits:</b>	20 preset kits, 10 user kits
<b>Song:</b>	50 preset songs
<b>Controls:</b>	POWER SWITCH, START/STOP, SAVE, KIT, VOICE/VOLUME, SONG/VOLUME, DRUM OFF, CLICK, HI-HAT, CRASH, RIDE, HI-HAT CONTROL, SNARE, TOM 1, TOM 2, TOM3, KICK, VOLUME, + / -, TEMPO + / -, TAP
<b>Display:</b>	LED display
<b>Connections:</b>	MIDI OUT Hi-hat control Hi-hat Crash Ride Snare Tom 1 Tom 2 Tom 3 Kick Output (R & L/MONO) Aux in
<b>Power Supply:</b>	AC adaptor (DC 9V)

# Voice List

<b>No.</b>	<b>Name</b>				
<b>Acoustic Base Drum</b>					
001	BD Head		054	RowDrum 1	
002	Real BD 1		055	RowDrum 2	
003	Real BD 2		056	RowDrum 3	
004	Real BD 6				
005	BD Std 1		<b>Electronic Snare Drum</b>		
006	BD Std 2		057	SD-Ana 2	
007	Room BD 1		058	SD-Ana 6	
008	Room BD 2		059	SD-Ana 7	
009	Lo BD		060	SD-Ana 11	
010	Rock BD 1		061	SD-Danc 5	
011	Rock BD 3		062	SD-Danc 6	
012	Rock BD 4		063	SD-Elec	
013	BD-Var 3		064	Syn-SD 1	
014	BD-Var 5		065	Syn-SD 7	
015	Big Drum 1		066	Syn-SD 8	
016	Big Drum 2		067	Syn-SD 11	
			068	Cool-SD 1	
			069	HD-SD 1	
			070	Brush 1	
			071	Brush 2	
			072	Brush 3	
			073	Brush 5	
			074	Brush 7	
			075	Brush 8	
			076	Brush 10	
			077	Brush 13	
<b>Electronic Base Drum</b>			<b>Acoustic Tom</b>		
017	BD-Analg		078	Tom-Std 5	
018	MrDance 1		079	Tom-Std 3	
019	MrDance 2		080	Tom-Std 2	
020	MrDance 5		081	Tom-Std 1	
021	Lo-BD 1		082	Tom-Jaz M	
022	Lo-BD 2		083	Tom-Jaz F	
023	Hard BD 3		084	Tom-Brs H	
			085	Tom-Brs M	
			086	Tom-Brs L	
			087	Tom-Brs F	
			088	Tom-BRK H	
			089	Tom-BRK M	
			090	Tom-BRK L	
			091	Tom-BRK F	
			092	Tom-Rom 6	
			093	Tom-Rom 5	
			094	Tom-Rom 4	
			095	Tom-Rom 3	
			096	Tom-Rom 2	
			097	Tom-Rom 1	
			098	Tom-Rm 2 L	
			099	Tom-Rm 2 F	
			<b>Electronic Tom</b>		
			100	TomH-A	
			101	Tom-A 5	
			102	Tom-A 4	
			103	Tom-A 3	
			104	Tom-A 2	
			105	Tom-A 1	
			106	Tom-T 1 M	
			107	Tom-T 3 L	
			108	Tom-T 3 F	
			109	Tom-EI 4	
			110	Tom-EI 3	
			111	Tom-EI 2	
			112	Tom-EI 1	
			<b>Cymbal</b>		
			113	CrashStd	
			114	CrashBrt	
			115	CrashSt 2	
			116	SftCrash	
			117	CrashSt 3	
			118	CrashSht	
			119	CrshThin	
			120	CrashRev	
			121	CrashRol	
			122	CrashSt 4	
			123	RideBel 1	
			124	RK Ride 2	
			125	RideBStd	
			126	Splash C 1	
			127	Cymbel 2	
			128	Cymbel 3	
			129	BigGong 1	
			130	BigGong 2	
			131	B.Cymb1 1	
			132	B.Cymb1 2	
			133	S.Cymb1 2	
			134	S.Cymb 2 M	
			135	SmalGong	
			<b>Hi-Hat</b>		
			136	H.H Cls 1	
			137	H.H Cls 3	
			138	H.H Cls 4	
			139	H.H Opn 1	
			140	H.HCNor 1	
			141	RK HHcls	
			142	H.H Opn 3	
			143	Open HH 2	
			144	Open HH 3	
			145	Open HH 4	
			146	RK HHOpn	
			147	Open HH 7	
			148	HH pedl 1	
			149	HH pedl 2	
			150	Ana Hh 1	
			<b>Percussion</b>		
			151	Agogo-1	
			152	Agogo-2	
			153	Bell Tre	
			154	Bongo Hi	
			155	Bongo Lo	
			156	Cabasa 1	
			157	Cabasa 2	
			158	Castanet	
			159	ClapA	
			160	Clavis 1	
			161	Clavis 2	
			162	Conga-Hi	
			163	Conga-M 1	
			164	Conga-M 2	
			165	Conga-3	
			166	Conga-4	
			167	Conga-5	
			168	CowBell 1	
			169	CowBell 2	
			170	Cuica H	
			171	Cuica L	
			172	Fsnap	
			173	Guiro 1	
			174	Guiro 2	
			175	HiQ	
			176	JingBell	
			177	Maracas 1	
			178	Maracas 2	
			179	MetroBel	
			180	MetroClk	
			181	Scrach	
			182	Shake	
			183	Surdo 1	
			184	Surdo 2	
			185	Tabla 1	
			186	Tabla 2	
			187	Tabla 3	
			188	Tabla 4	
			189	TalkD	
			190	TalknDrD	
			191	TalknDrU	
			192	TalknDrV	
			193	Tambouri	
			194	TimbleH	
			195	TimbleL	
			196	TimblePH	
			197	TimblePL	
			198	Triangle	
			199	TriagMut	
			200	VibrSlap	
			201	Whistal	
			202	XfadeTri	
			203	Smallwod	
			204	BoardDr 1	
			205	BoardDr 2	
			206	LotusBrd	
			207	BanbuBrd	
			208	SouthBan	
			209	B.WdFish	
			210	S.WdFis 1	
			211	S.WdFis 2	
			212	S.WdFis 3	
			213	S.WdFis 4	
			214	ImpacBel	
			215	ImpaBel M	

## Drum Kit List

No.	Name	No.	Name
001	Standard 1	011	Jazz
002	Standard 2	012	Brush 2
003	Dance 1	013	Dance Stick
004	Jazz Latin	014	Orchestra
005	Room 1	015	Drum & Bass
006	Electric	016	House
007	Brush	017	Rhythm & Blues
008	Room Stick	018	Ungle
009	Latin 1	019	China LuoGu
010	Latin 2	020	Oriental 1

## Song List

No.	Name	Beat	No.	Name	Beat
001	Guitar	4/4	026	Reggae	4/4
002	Accordion Fusion	4/4	027	Shuffle 1	4/4
003	Folk Pop	4/4	028	Rhythm & Blues 3	4/4
004	Rock	4/4	029	Rock 'N' Roll 1	4/4
005	Blues	4/4	030	8 Beat 4	4/4
006	Newage	4/4	031	8 Beat 2	4/4
007	Reggae Funk	4/4	032	16 Beat	4/4
008	Drum & Bass	4/4	033	March	4/4
009	Pop 8 Beat	4/4	034	Latin 6	4/4
010	Dance	4/4	035	Funk 3	4/4
011	Drk -2	4/4	036	Fusion 2	4/4
012	Pop 3	4/4	037	Rock 'N' Roll 2	4/4
013	Pop 5	4/4	038	Hard Rock 3	4/4
014	Jazz 1	4/4	039	Rock Pop 2	4/4
015	Rhythm & Blues 4	6/8	040	Funk 1	4/4
016	Ballad 1	4/4	041	Funk 4	4/4
017	Ballad 2	4/4	042	Jazz 3	6/8
018	Ballad 4	4/4	043	Dance 1	4/4
019	Ballad 5	4/4	044	Dance 2	4/4
020	Ballad 6	4/4	045	Mambo	4/4
021	Waltz	3/4	046	Rhythm & Blues 1	4/4
022	Slow Rock	6/8,9/8	047	Rhythm & Blues 2	4/4
023	Rock Pop 4	4/4	048	Ballad 3	4/4
024	Latin 4	4/4	049	Jing Opera	4/4
025	Latin 5	4/4	050	Chinese Rhythm	2/4

# MIDI Implementation Chart

	Function...	Transmitted	Remarks
Basic Channel	Default Changed	10 ch X	
Mode	Default Messages Altered	X X *****	
Note Number:	True voice	0 - 127 *****	
Velocity	Note on Note off	O 9nH, V= 1 - 127 X (9nH. V= 0)	
After Touch	Key's Channel's	X X	
Pitch Bend		X	
Contro Change	0 1 5 6 7 10 11 64 65 66 67 80 81 91 93 120 121 123	X X X X X X X X X X X X X X X X X X	Bank Select Modulation Portamento Time Data Entry Volume Pan Expression Sustain Pedal Portamento ON/OFF Sostenuto Pedal Soft Pedal Reverb Program Chorus Program Reverb Level Chorus Level All Sound OFF Reset All Controller All Notes OFF
Program Change:	True #	X	
System	Exclusive	X	
System Common	: Song Position : Song Select : Tune	X X X	
System Real Time	: Clock : Commands	X X	
Aux Messages	: Local ON/OFF : All Notes OFF : Active Sense : Reset	X X X X	

O : YES

X : NO

